



Killeshal Precast  
Concrete Ltd Daingean,  
Co. Offaly, Ireland

Tel: +353 57 9353018  
Fax: +353 57 9353272  
E-Mail: sales@killeshal.com  
Web: www.killeshal.com

J/B 519

Junction Box Cover

Product Code	094.519		
Doc Ref: -Kilform	286/04/08	Rev Lvl	8
Drawn By	A.N.	22/08/2019	Approved By
Approx Weight	215Kgs	P.N. 22/08/19	

Note: All Vertical Faces Would Typically have a Taper of 4 mm in 100 mm.

All dimensions as per drawing and subject to tolerances of +/-4mm.

Drawing prepared by Alan Nugent. The release of this drawing confirms dimensions as stated have been checked and are correct.

Moulds:-  
1no. gang of 4 Moulds.

**MIX DESIGN**

Recipe: 22 Lintels Dry Cast	Quantity: 0.950m3	Water/Cem: 0.378	Water In Agg: 53.5ltrs	Water Adjust: 1.0ltrs			
Material (Bin)	Dry	Wet	Actual	Moist.	Material (Bin)	Target	Actual
F.Sand (Agg 1)	855	910	917kgs	6.00%	Cement (Silo 4)	323	332kgs
10mm Pebble (Agg 4)	665	672	670kgs	1.00%	Water (Wtr)	75	72ltrs
14mm Chips (Agg 5)	190	192	212kgs	1.00%			
Mix Moist. (Dry)				2.51%			
Mix Moist. (Wet)				5.30%			

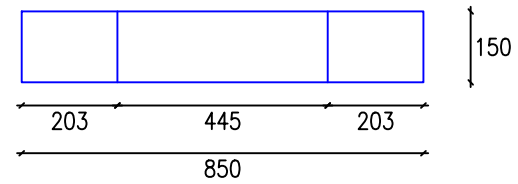
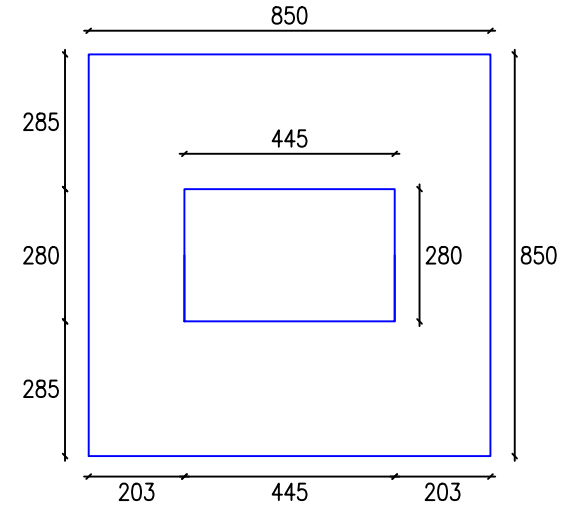
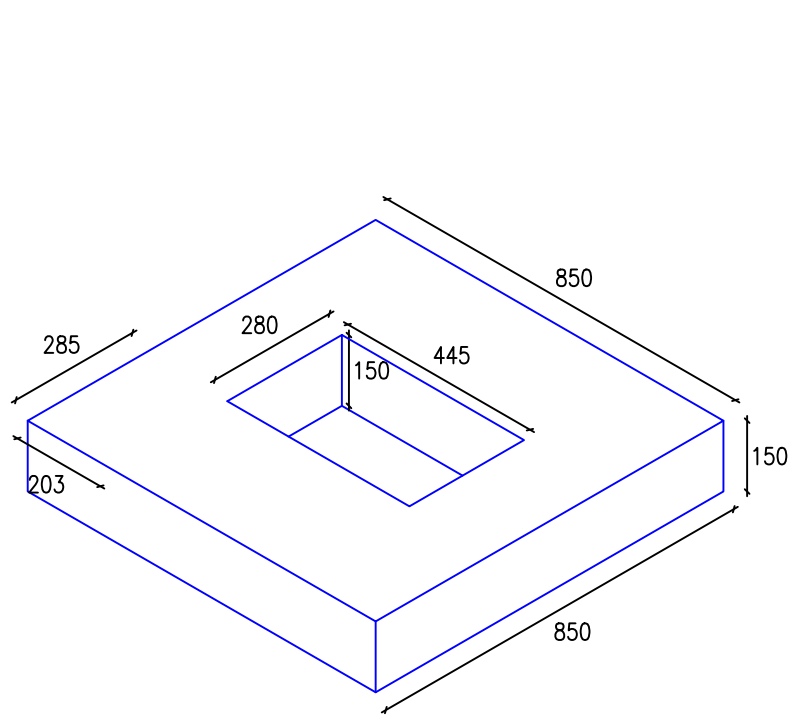

Scale (1:16)